



Product Codes
5730, 5830, 5740, 5840

LUME - Euro Locking - Timber Door

Step 1 - Flush Pull Crop Out*

- Ensure the critical 55mm backset measurement is correct before cutting.
- Select install block fixing face fixed (option 1) or vertically fixed (option 2).
- Cut Rebate Option 1 - for face fixed install blocks (recommended).
- Cut Rebate Option 2 - for vertically fixed install blocks.

**Refer to detailed crop out template provided.*

Step 2 - Lock Case Crop Out*

- Cut 3mm face plate rebate.
- Select lock case rebate option 1 or option 2.
- Cut rebate option 1 – for face plate without integrated edge pull.
- Cut rebate option 2 – for face plate with integrated edge pull.
- Cut lock case rebate through to flush pull rebate.

**Refer to detailed crop out template provided.*

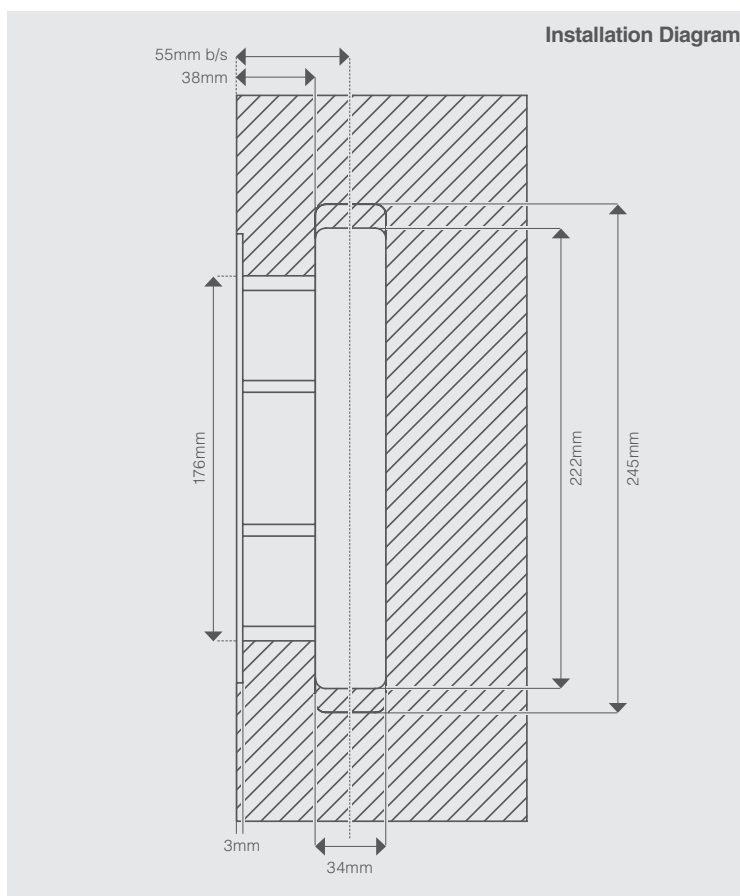

Step 3 - Install Blocks

- Apply install blocks to flush pull rebate.
- Use 4 x supplied wood screws to either face fix or vertically.
- Repeat for the opposite side.

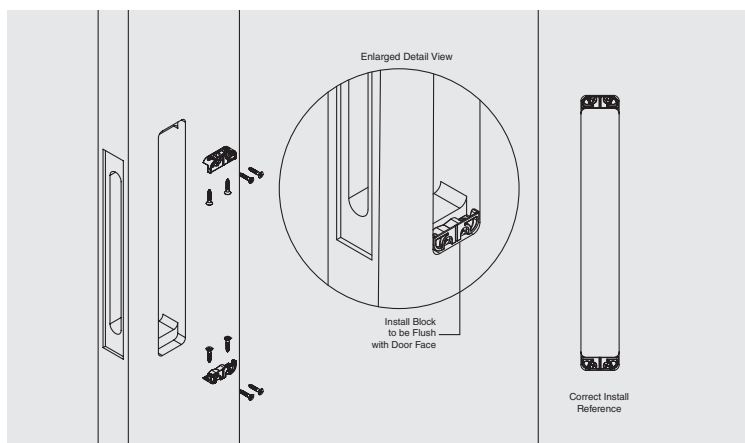

Step 4 - Lock Case Install

- Install the lock case.
- Use the two supplied wood screws to fix the lock case in place.
- Ensure the face plate sits flush with the door edge.

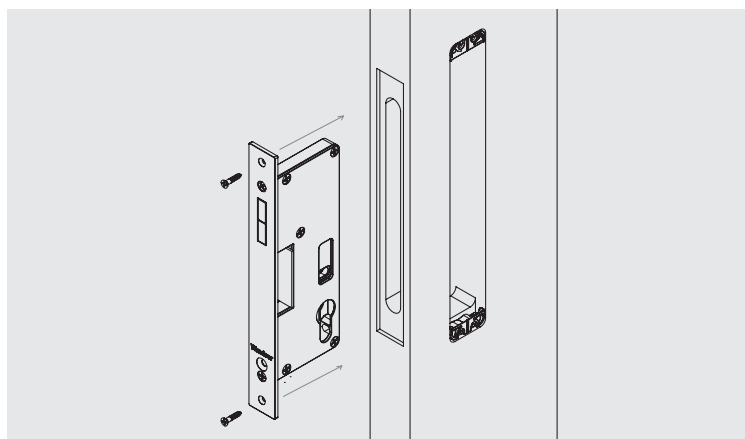



Product Codes
5730, 5830, 5740, 5840

LUME - Euro Locking - Timber Door

Step 5 - Snib Action Flush Pull Install 1:

- Install the first flush pull.
- Ensure the top fixing grub screw is flush or sub flush with face A.
- Insert the flush pull. Ensuring that Face B sits hard up against the door face.
- Tighten the top fixing grub screw to lock the flush pull in place.

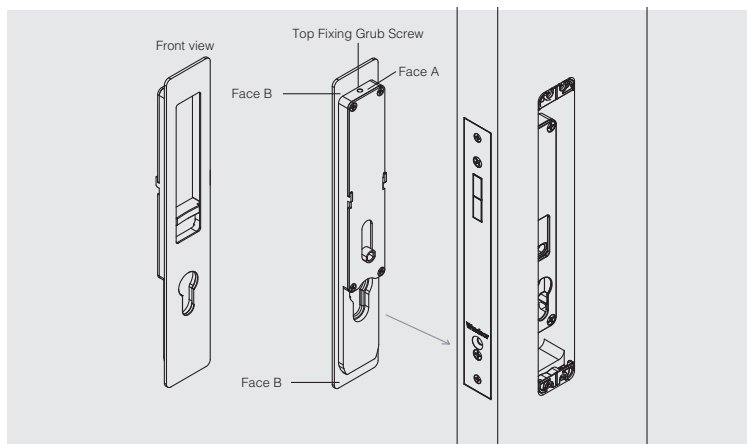

Step 6 - Snib Flush Pull Install 2:

- Select the correct length snib rod for the door thickness.
- Install the snib rod - guide the snib rod through the lock case throw and into the pre-installed flush pull snib.
- With the snib rod in place. Install the second flush pull repeating **Step 5**. Ensuring the snib engages with the snib rod.
- Tighten the top fixing grub screw to lock the flush pull in place.
- Test the assembly by moving one or both flush pull snibs. Correct operation will open the lock case Mortice.

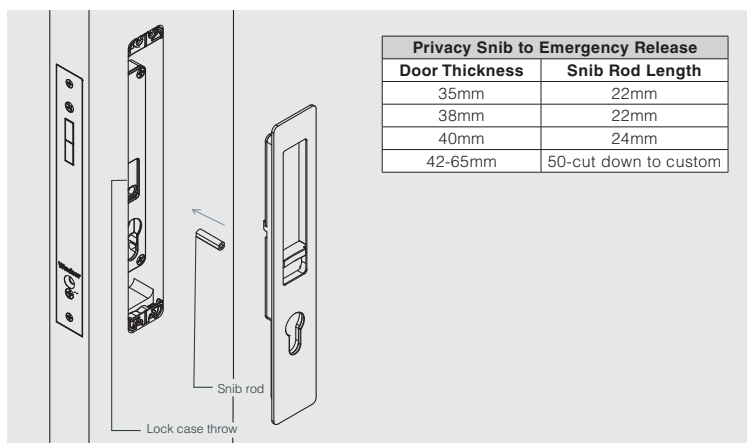

Step 7 - Euro Cylinder Installation

- Choose the correct length euro cylinder for the door thickness.
- Insert the euro cylinder through flush pull and lock case to align cylinder screw.
- Use the supplied cylinder screw to lock the cylinder in place.
- Test the lock with the key to ensure a correct install.

Tips

- If alignment issues occur between flush pull and lock case, slightly loosen flush pull grub screws and all 4 face plate screws to allow adjustment.
- Once the cylinder is in the correct position. Tighten the fixings.
- Use the key to help guide the cylinder in place

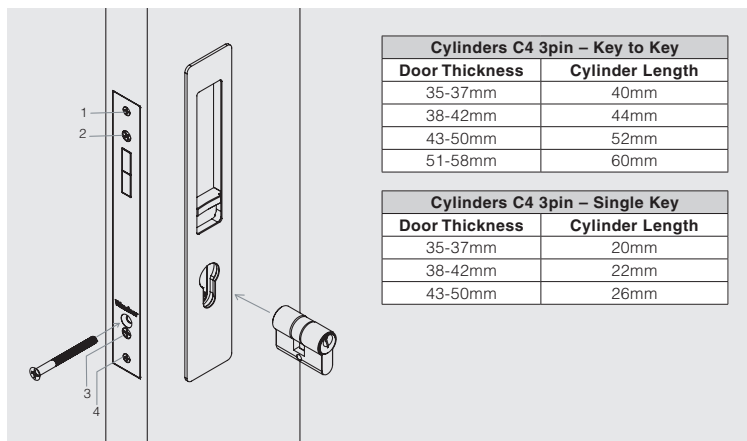

Step 8 - Timber Door Strike Installation

- Ensure crop out centre point aligns with lock case mortice centre point.
- Fix dust box and face plate in place.
- Ensure face plate is flush.
- Test the strike with the mortise to ensure correct installation.

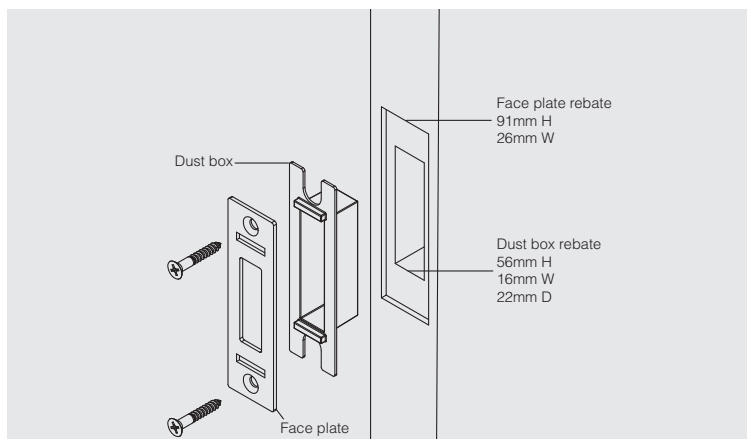



Product Codes
5730, 5830, 5740, 5840

LUME - Euro Locking - Timber Door - FLUSH PULL (250mm)

- A.** Ensure the critical 55mm backset measurement is correct before cutting.
- B.** Select install block fixing face fixed (option 1) or vertically fixed (option 2).
- C.** Cut Rebate Option 1 - for face fixed install blocks (recommended).
- D.** Cut Rebate Option 2 - for vertically fixed install blocks.

FLUSH PULL REBATE OPTION 1 (Face fixed install blocks)

SECTION A-A

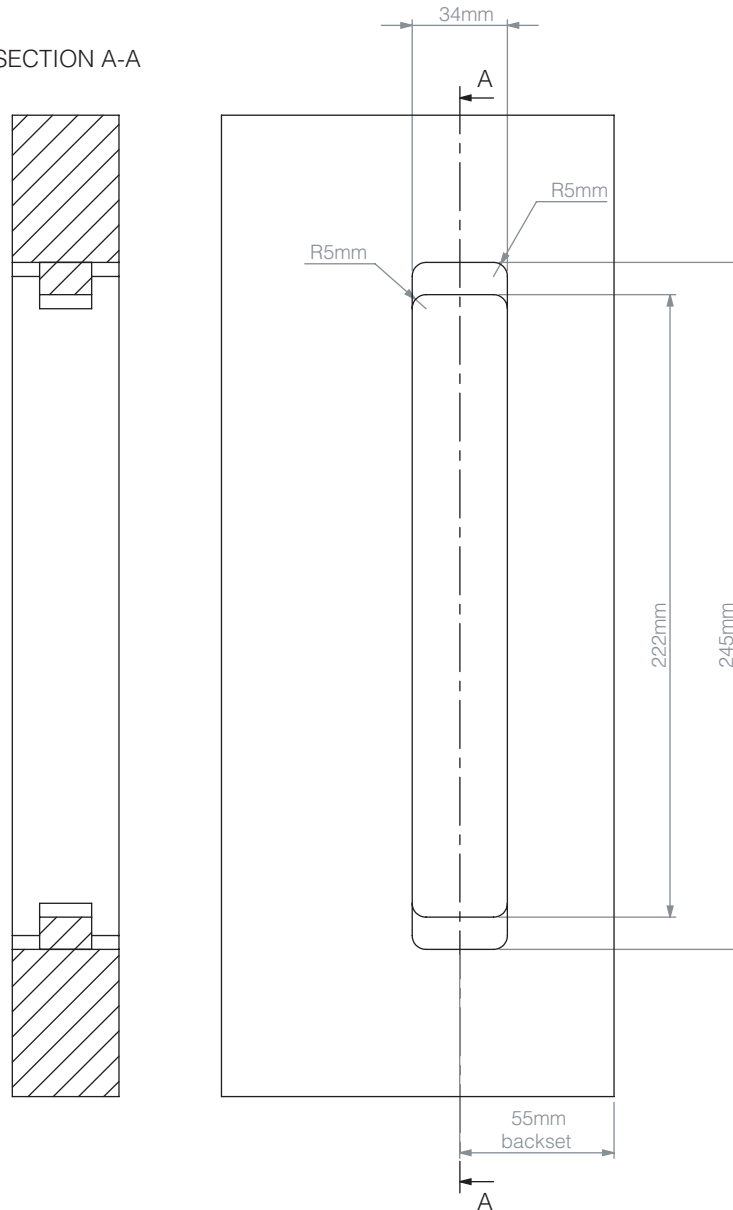

FLUSH PULL REBATE OPTION 2 (Vertical fixed install blocks)

SECTION B-B

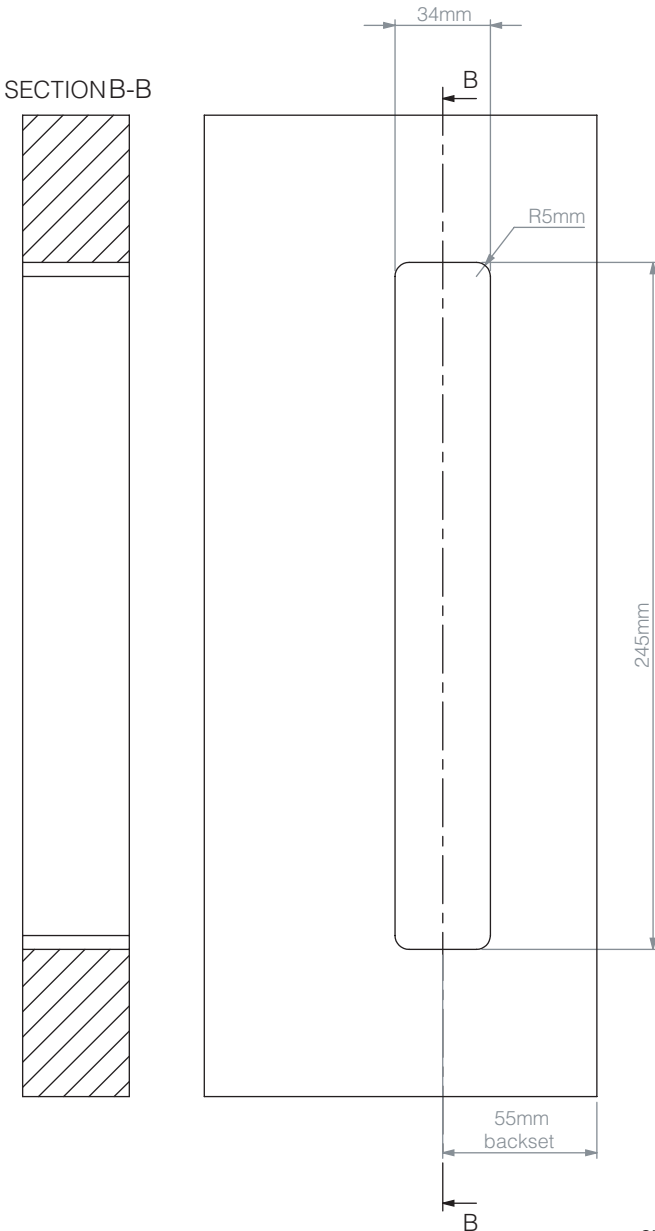



Product Codes
5730, 5830, 5740, 5840

LUME - Euro Locking - Timber Door - LOCK CASE (55mm Backset)

- Cut 3mm face plate rebate.
- Select lock case rebate option 1 or option 2.
- Cut rebate option 1 – for face plate without integrated edge pull.
- Cut rebate option 2 – for face plate with integrated edge pull.
- Cut lock case rebate through to flush pull rebate.

3MM FACE PLATE REBATE

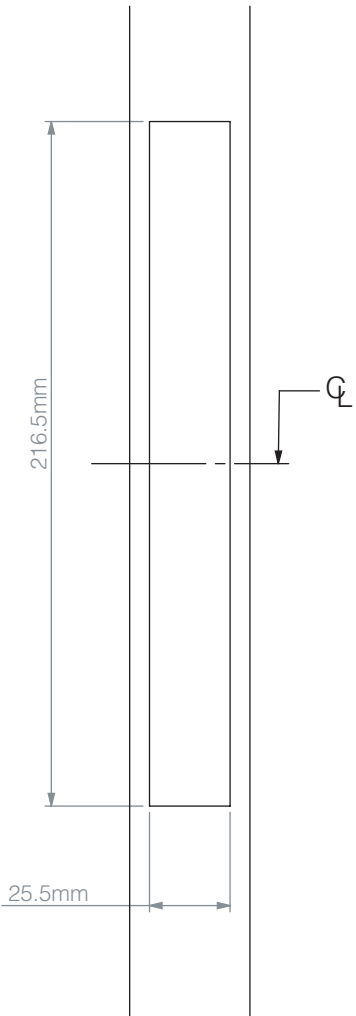

LOCK CASE REBATE OPTION 1 (Face plate without integrated edge pull)

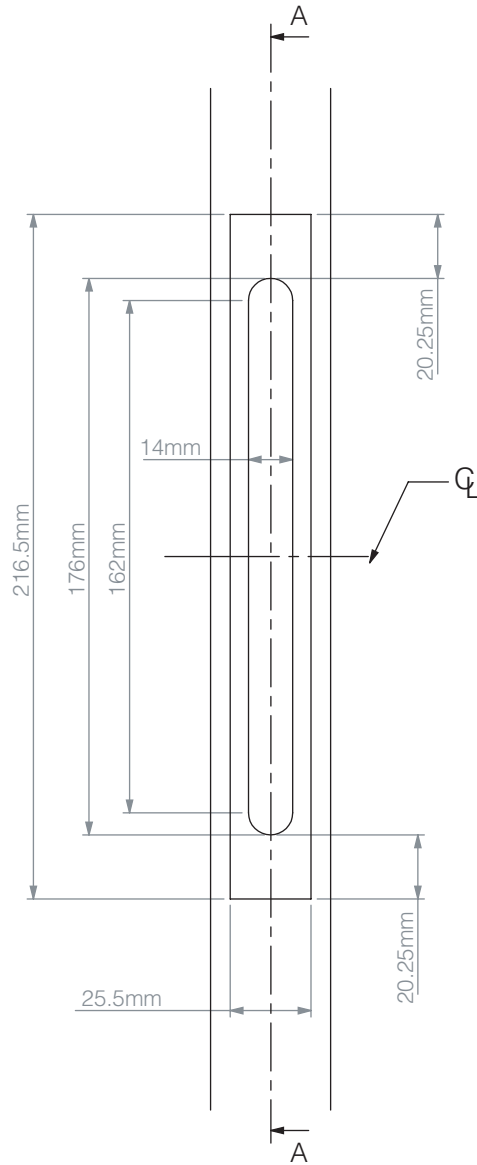

LOCK CASE REBATE OPTION 2 (Face plate with integrated edge pull)

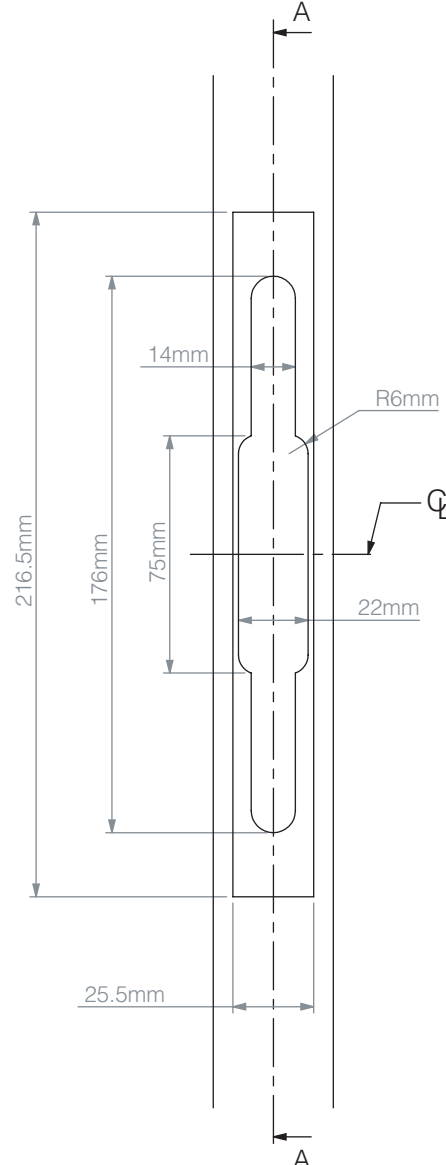

LOCK CASE REBATE DETAILED

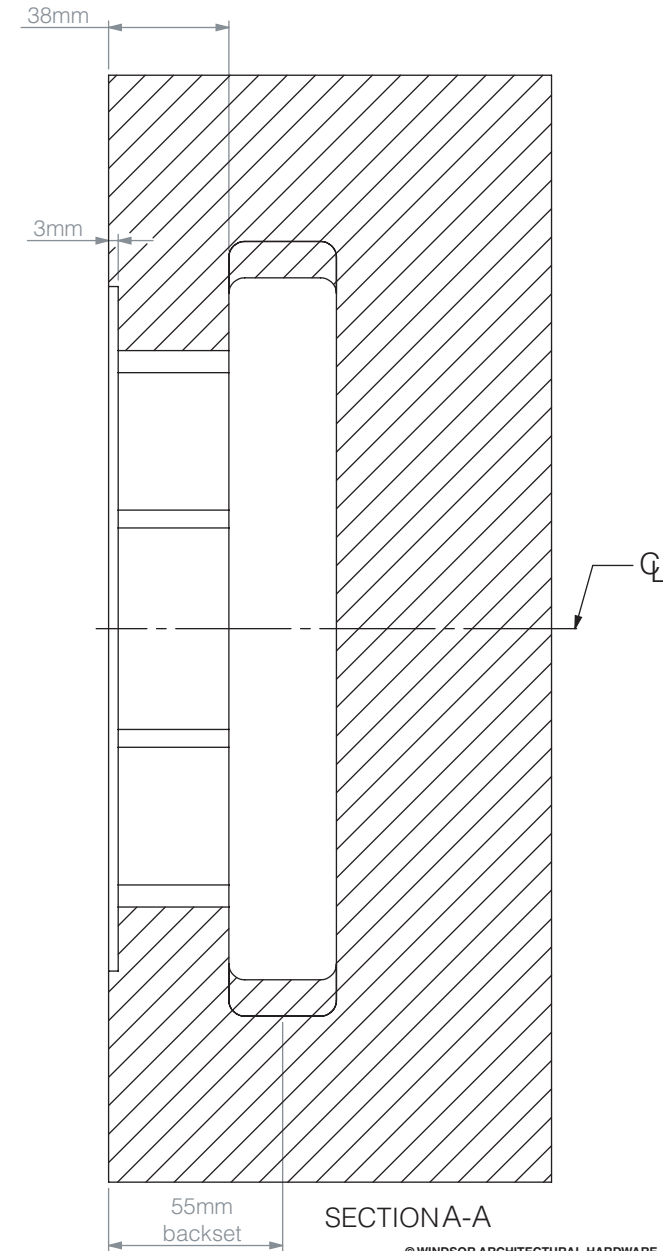

SECTION A-A

© WINDSOR ARCHITECTURAL HARDWARE