



Product Codes
5700, 5800, 5710,
5810, 5720, 5820

LUME - Privacy Set - Timber Door

Step 1 - Flush Pull Crop Out*

- Ensure the critical 55mm backset measurement is correct before cutting.
- Select install block fixing face fixed (option 1) or vertically fixed (option 2).
- Cut Rebate Option 1 - for face fixed install blocks (recommended).
- Cut Rebate Option 2 - for vertically fixed install blocks.

**Refer to detailed crop out template provided.*

Step 2 - Lock Case Crop Out*

- Cut 3mm face plate rebate.
- Select lock case rebate option 1 or option 2.
- Cut rebate option 1 – for face plate with integrated edge pull.
- Cut rebate option 2 – for face plate without integrated edge pull.
- Cut lock case rebate through to flush pull rebate.

**Refer to detailed crop out template provided.*

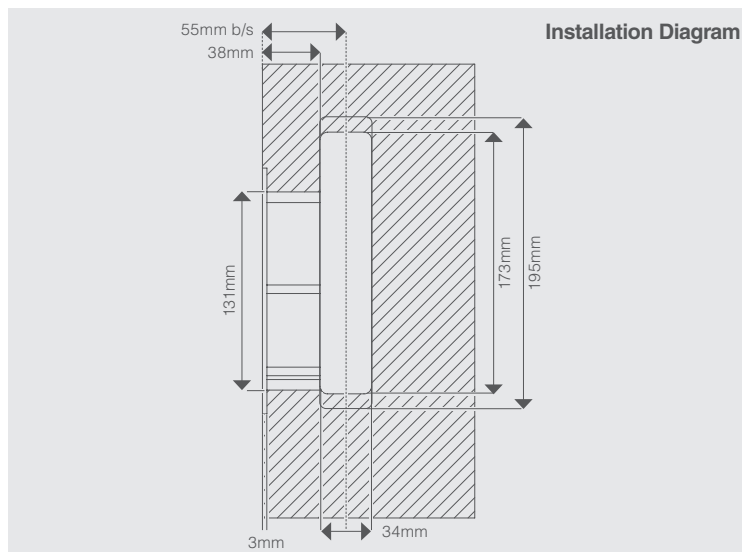

Step 3 - Install Blocks

- Apply install blocks to flush pull rebate.
- Use 4 x supplied wood screws to either face fix or vertically.
- Repeat for the opposite side.

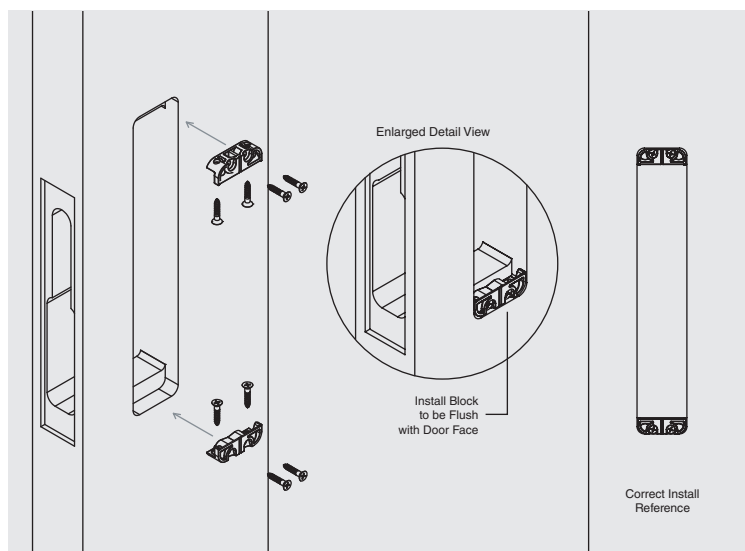

Step 4 - Lock Case Install

- Install the lock case.
- Use the two supplied wood screws to fix the lock case in place.
- Ensure the face plate sits flush with the door edge.

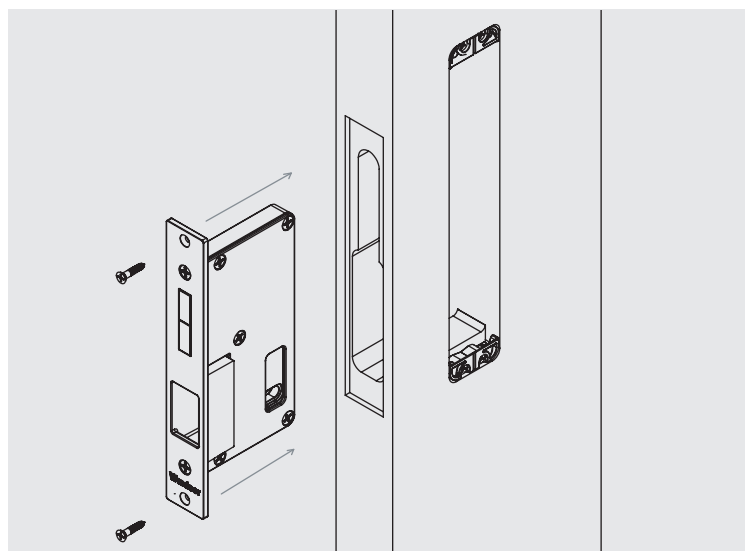



Product Codes
5700, 5800, 5710,
5810, 5720, 5820

LUME - Privacy Set - Timber Door

Step 5 - Snib Action Flush Pull Install

- Install flush pull with snib action.
- Ensure the top fixing grub screw is flush or sub flush with face A.
- Insert the flush pull in place ensuring that face B sits hard up against the door face.
- Tighten the top fixing grub screw to lock the flush pull in place.

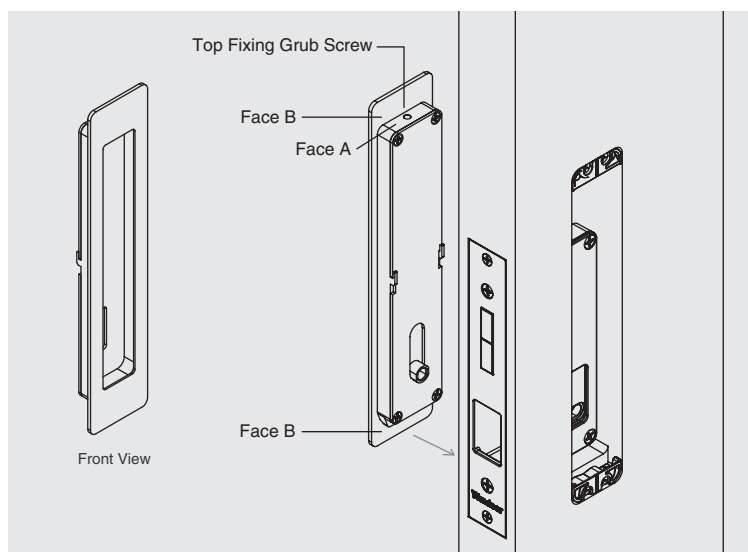

Step 6 - Emergency Release Flush Pull

- Select the correct length snib rod for the door thickness.
- Attach the snib rod to the emergency release snib using the supplied screw.
- Ensure the top fixing grub screw is flush or sub as per [Step 5](#).
- Install the emergency release snib rod assembly - guide the snib rod through the lock case throw and into the pre-installed flush pull snib.
- With the snib rod in place. Install the flush pull repeating [Step 5](#).
- Tighten the top fixing grub screw to lock the flush pull in place.
- Test the assembly by moving the flush pull snib.
Correct operation will open the lock case Mortice.

Privacy Snib to Emergency Release	
Door Thickness	Snib Rod Length
35mm	18mm
38mm	18mm
40mm	20mm
42mm	22mm
42mm+	50-cut down to custom

Privacy Snib to Snib Install Option	
Door Thickness	Snib Rod Length
35mm	22mm
38mm	22mm
40mm	24mm
42mm-65mm	50-cut down to custom

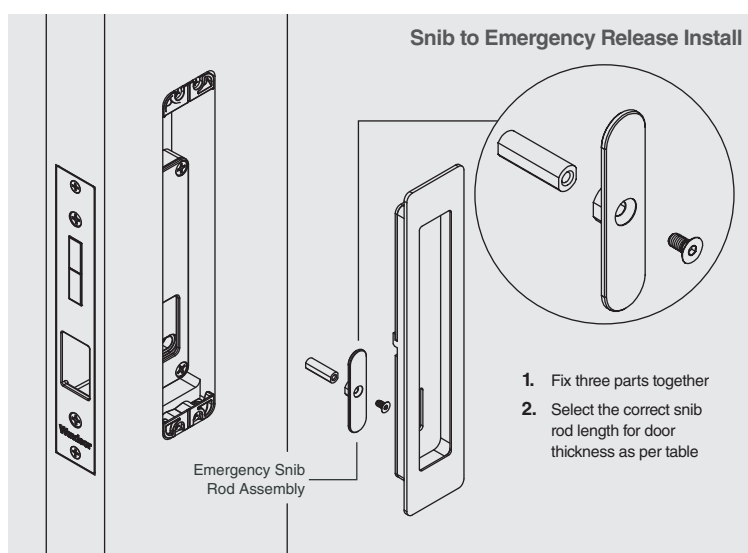

- Fix three parts together
- Select the correct snib rod length for door thickness as per table

Step 7 - Timber Door Strike Installation

- Ensure crop out centre point aligns with lock case mortice centre point.
- Fix dust box and face plate in place.
- Ensure face plate is flush.
- Test the strike with the mortise to ensure correct installation.

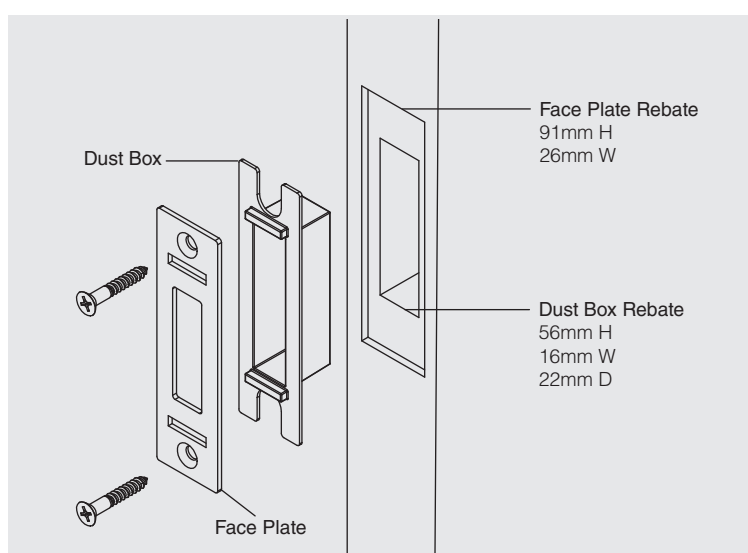



- A.** Ensure the critical 55mm backset measurement is correct before cutting
- B.** Select install block fixing face fixed (option 1) or vertically fixed (option 2).
- C.** Cut rebate option 1 - for face fixed install blocks (Recommended).
- D.** Cut rebate option 2 - for vertically fixed install blocks.

FLUSH PULL REBATE OPTION 1 (Face fixed install blocks)

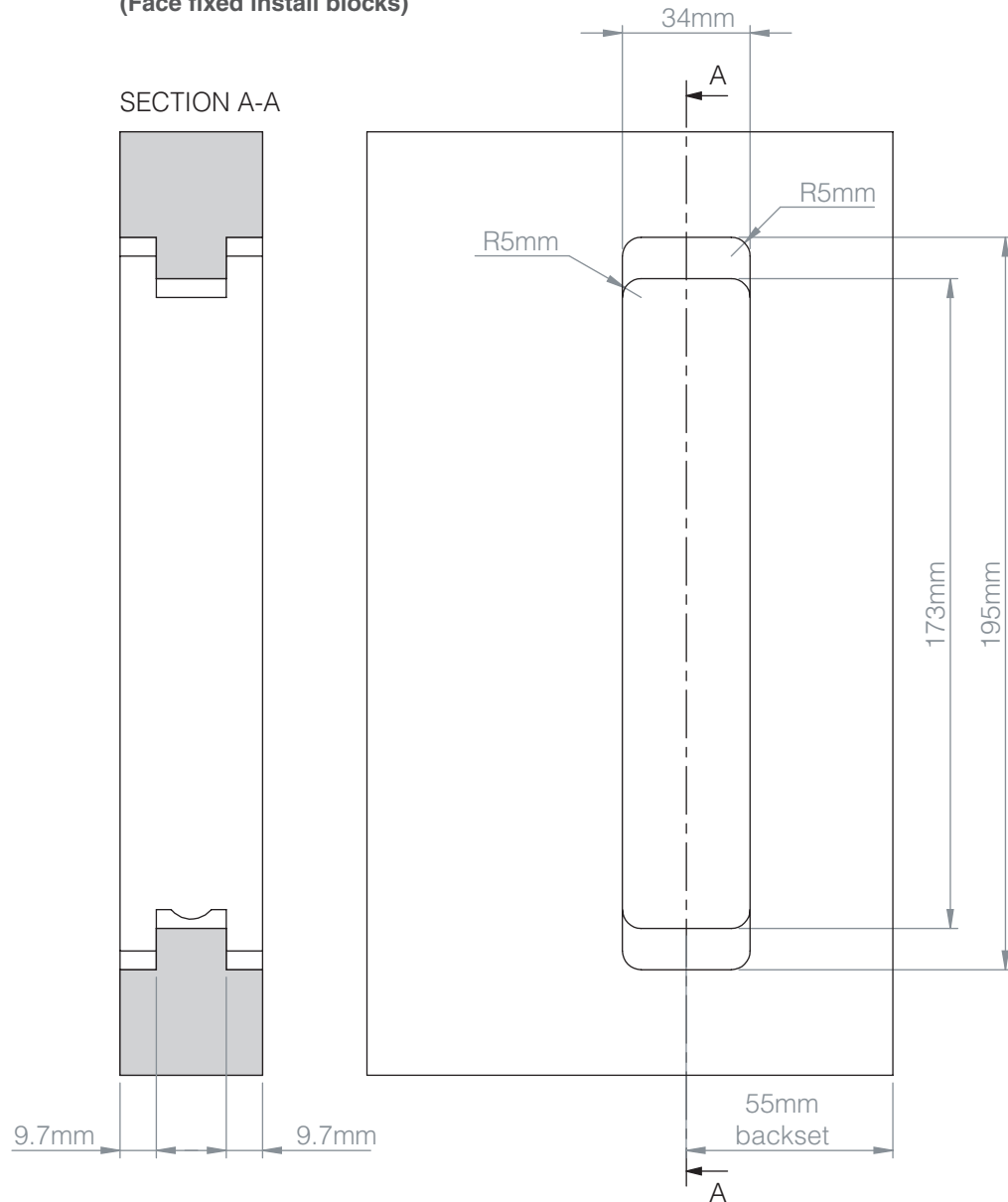

FLUSH PULL REBATE OPTION 2 (Vertical fixed install blocks)

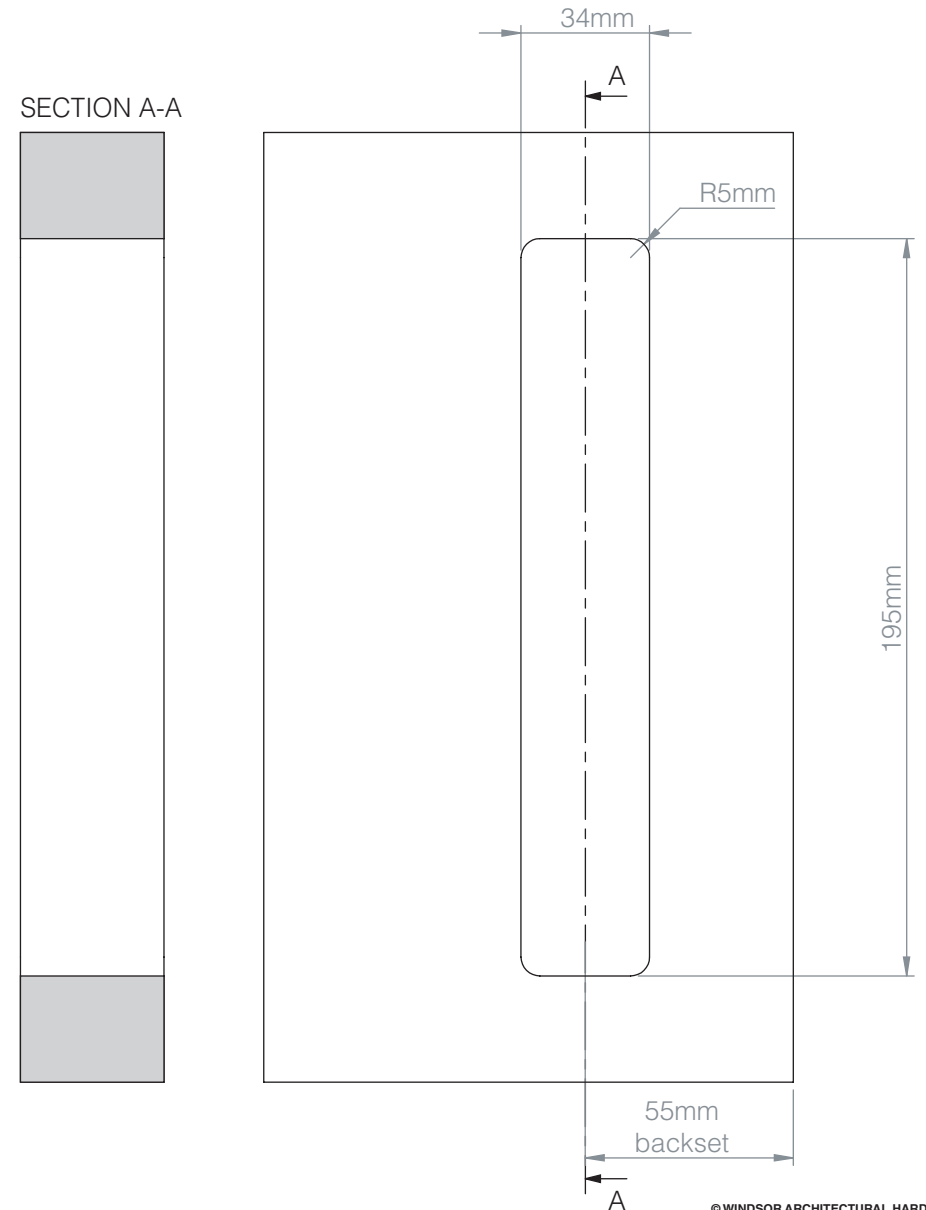



- A. Cut 3mm face plate rebate.
- B. Select lock case rebate option 1 or option 2.
- C. Cut rebate option 1 – for face plate with integrated edge pull.
- D. Cut rebate option 2 – for face plate without integrated edge pull.
- E. Cut lock case rebate through to flush pull rebate.

Product Codes

5700, 5800, 5710, 5810, 5720, 5820

LUME - Privacy Set - Timber Door - LOCK CASE (55mm Backset)

3MM FACE PLATE REBATE

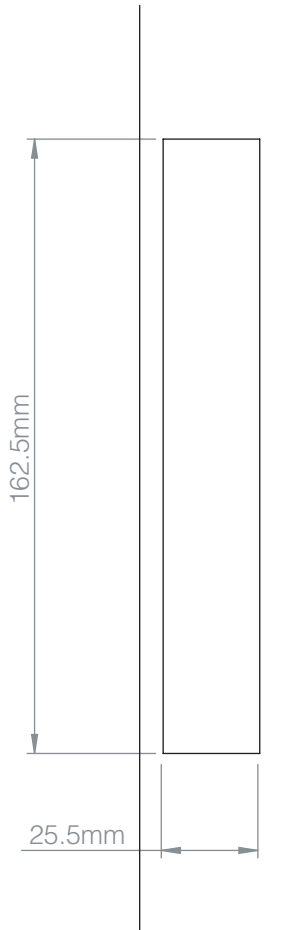

LOCK CASE REBATE OPTION 1 (Face plate with integrated edge pull)

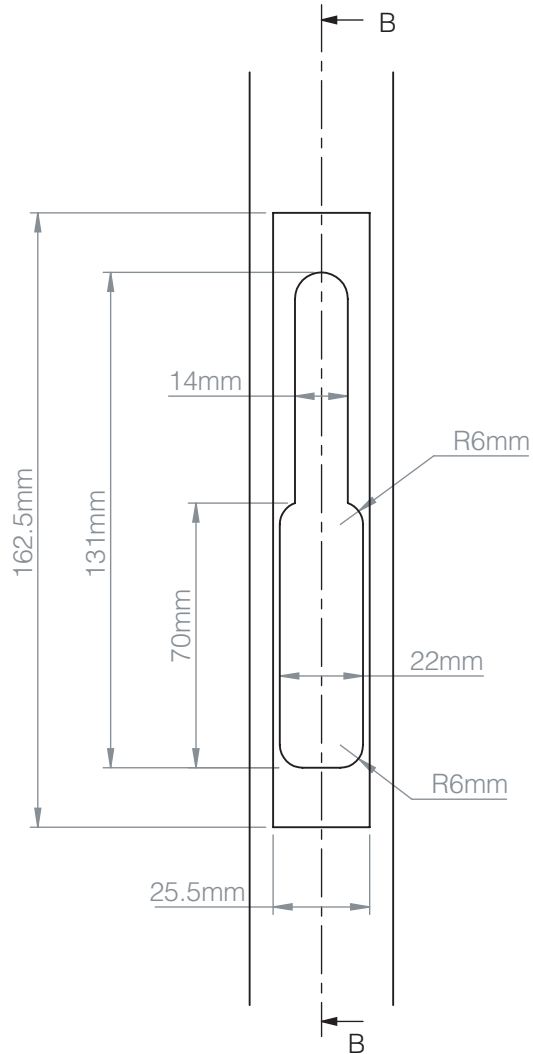

LOCK CASE REBATE OPTION 2 (Face plate without integrated edge pull)

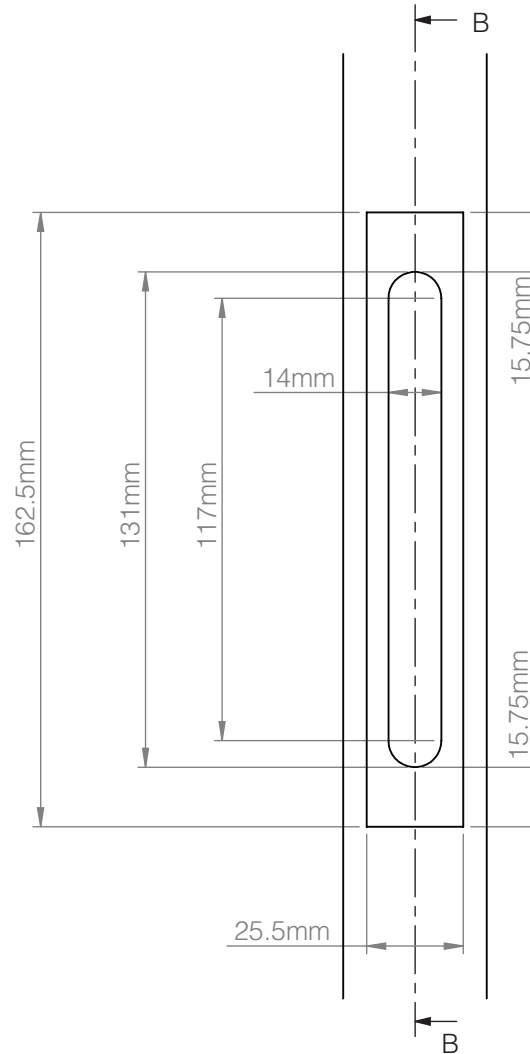

LOCK CASE REBATE DETAILED

