



**Product Codes**  
5730, 5830, 5740, 5840

### LUME - Euro Locking - Timber Door

#### Step 1 - Flush Pull Crop Out\*

- A. Ensure the critical 55mm backset measurement is correct before cutting.
- B. Select install block fixing face fixed (option 1) or vertically fixed (option 2).
- C. Cut Rebate Option 1 - for face fixed install blocks (recommended).
- D. Cut Rebate Option 2 - for vertically fixed install blocks.

**\*REFER TO DETAILED CROP OUT TEMPLATE PROVIDED.**

#### Step 2 - Lock Case Crop Out\*

- A. Cut 3mm face plate rebate.
- B. Select lock case rebate option 1 or option 2.
- C. Cut rebate option 1 - for face plate without integrated edge pull.
- D. Cut rebate option 2 - for face plate with integrated edge pull.
- E. Cut lock case rebate through to flush pull rebate.

**\*REFER TO DETAILED CROP OUT TEMPLATE PROVIDED.**

Installation Diagram

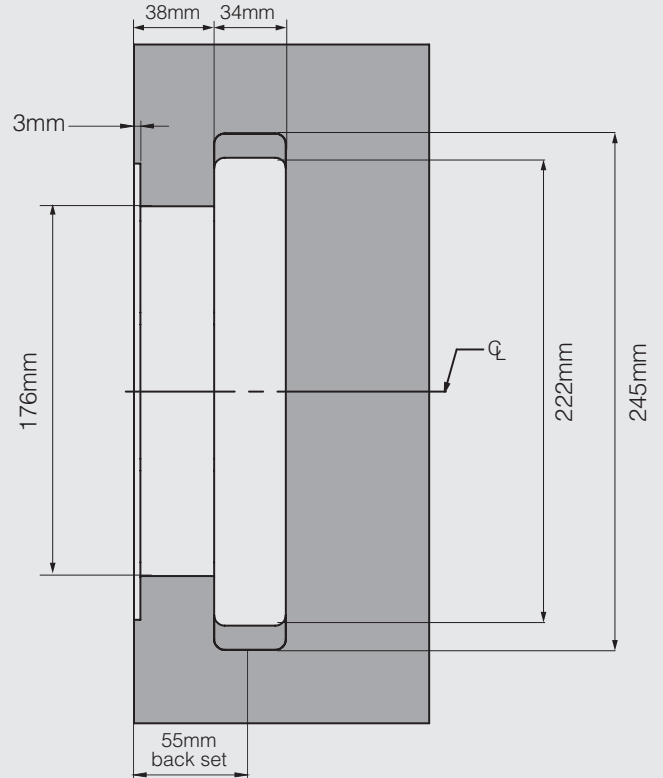

#### Step 3 - Install Blocks

- A. Apply install blocks to flush pull rebate.
- B. Use 4 x supplied wood screws to either face fix or vertically.
- C. Repeat for the opposite side.

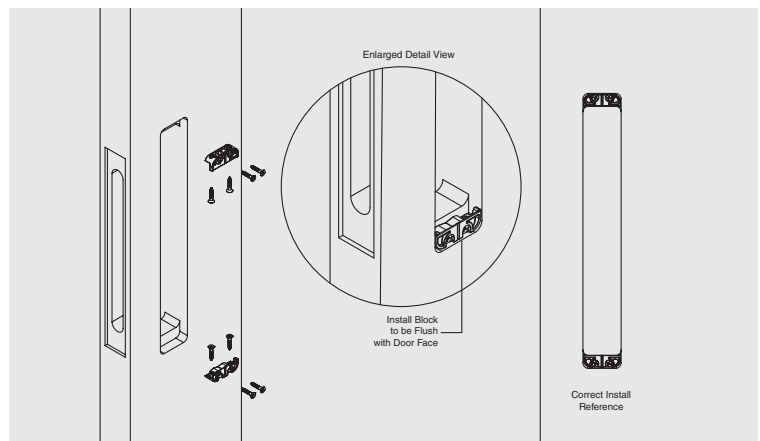

#### Step 4 - Lock Case Install

- A. Install the lock case.
- B. Use the two supplied wood screws to fix the lock case in place.
- C. Ensure the face plate sits flush with the door edge.

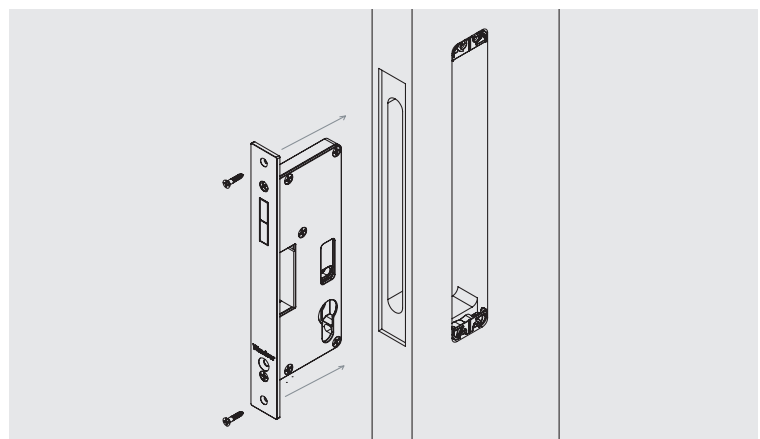



**Product Codes**  
5730, 5830, 5740, 5840

### LUME - Euro Locking - Timber Door

#### Step 5 - Snib Action Flush Pull Install 1:

- Install the first flush pull.
- Ensure the top fixing grub screw is flush or sub flush with face A.
- Insert the flush pull. Ensuring that Face B sits hard up against the door face.
- Tighten the top fixing grub screw to lock the flush pull in place.

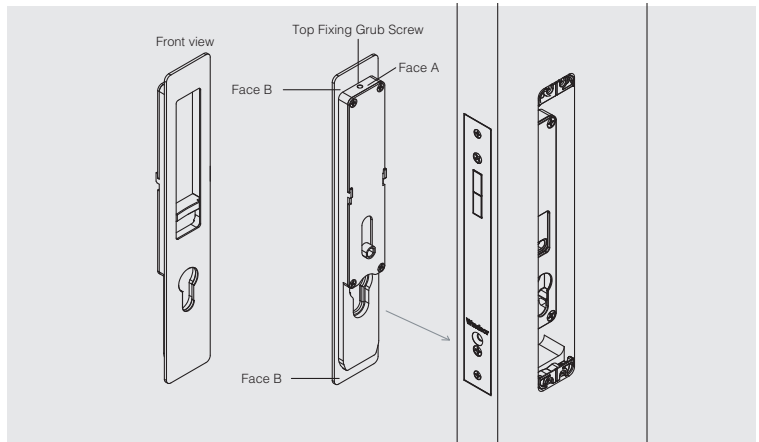

#### Step 6 - Snib Flush Pull Install 2:

- Select the correct length snib rod for the door thickness.
- Install the snib rod - guide the snib rod through the lock case throw and into the pre-installed flush pull snib.
- With the snib rod in place. Install the second flush pull repeating **Step 5**. Ensuring the snib engages with the snib rod.
- Tighten the top fixing grub screw to lock the flush pull in place.
- Test the assembly by moving one or both flush pull snibs. Correct operation will open the lock case Mortice.

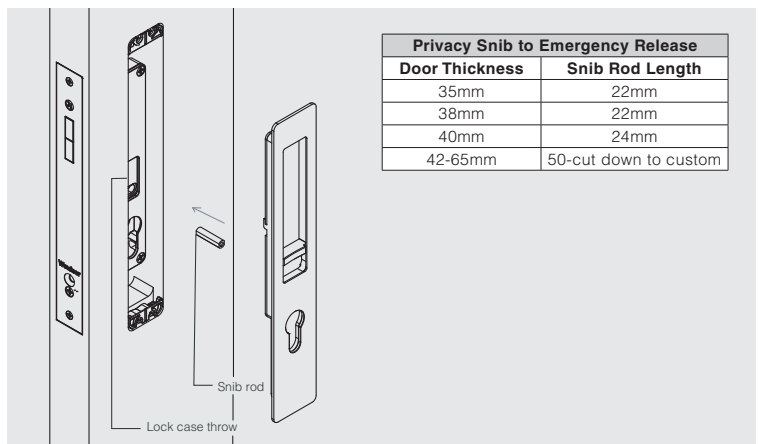

#### Step 7 - Euro Cylinder Installation

- Choose the correct length euro cylinder for the door thickness.
- Insert the euro cylinder through flush pull and lock case to align cylinder screw.
- Use the supplied cylinder screw to lock the cylinder in place.
- Test the lock with the key to ensure a correct install.

#### Tips

- If alignment issues occur between flush pull and lock case, slightly loosen flush pull grub screws and all 4 face plate screws to allow adjustment.
- Once the cylinder is in the correct position. Tighten the fixings.
- Use the key to help guide the cylinder in place

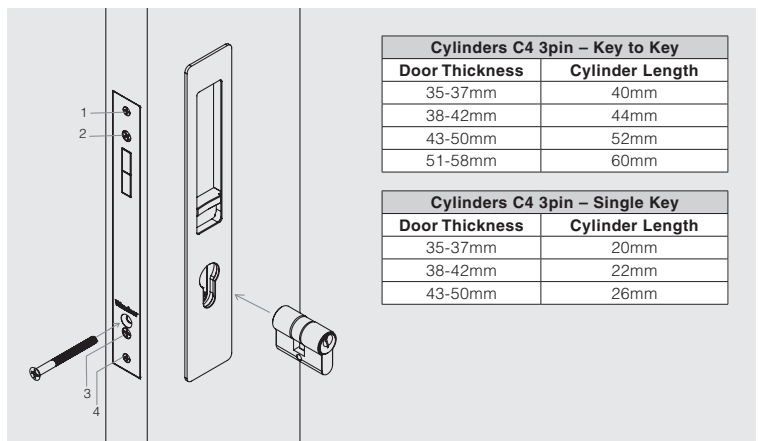

#### Step 8 - Timber Door Strike Installation

- Ensure crop out centre point aligns with lock case mortice centre point.
- Fix dust box and face plate in place.
- Ensure face plate is flush.
- Test the strike with the mortise to ensure correct installation.

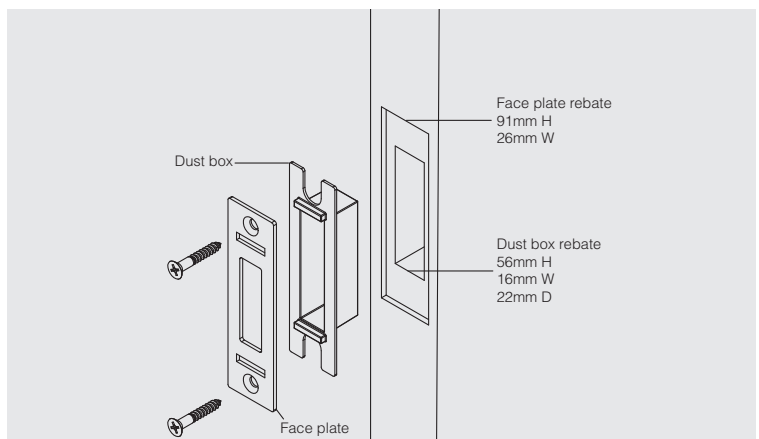



- A. Ensure the critical 55mm backset measurement is correct before cutting.
- B. Select install block fixing face fixed (option 1) or vertically fixed (option 2).
- C. Cut Rebate Option 1 - for face fixed install blocks (recommended).
- D. Cut Rebate Option 2 - for vertically fixed install blocks.

Product Codes  
5730, 5830, 5740, 5840

LUME - Euro Locking - Timber Door - FLUSH PULL (250mm)

### FLUSH PULL REBATE OPTION 1 (Face fixed install blocks)

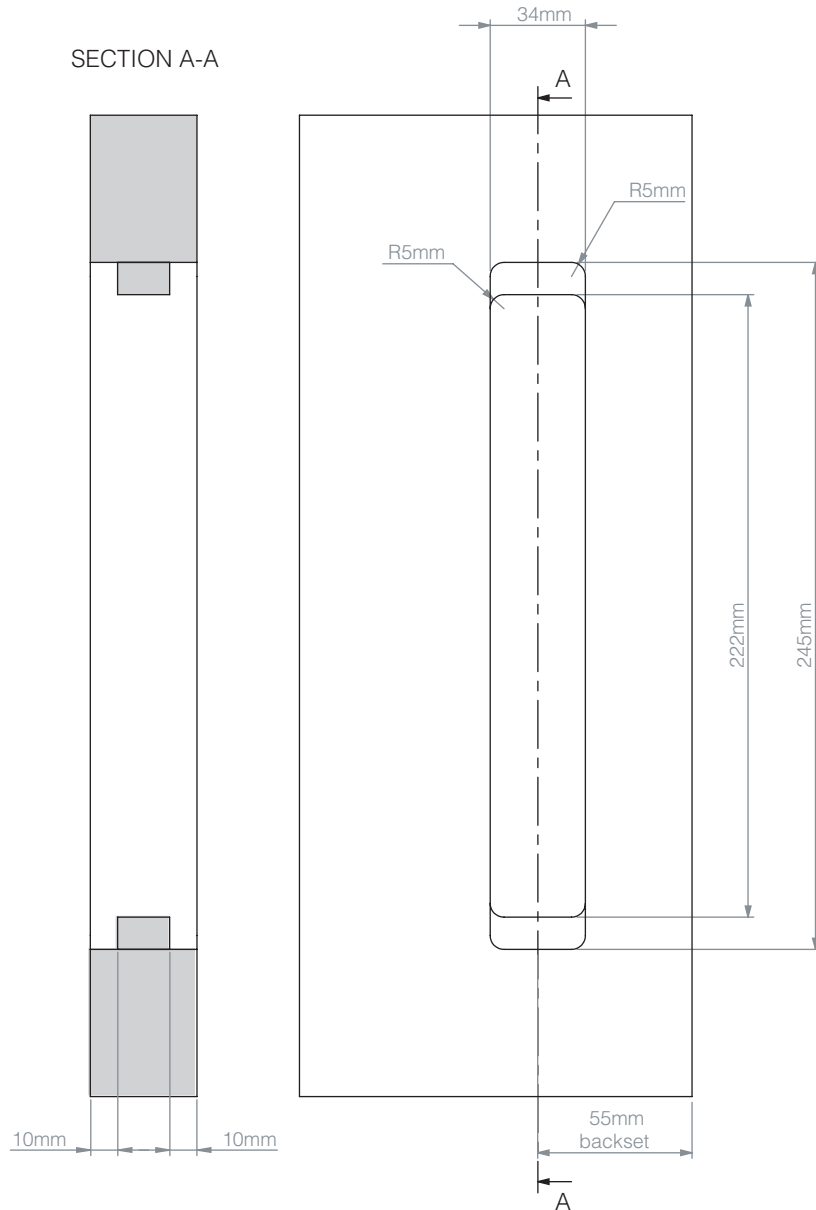

### FLUSH PULL REBATE OPTION 2 (Vertical fixed install blocks)

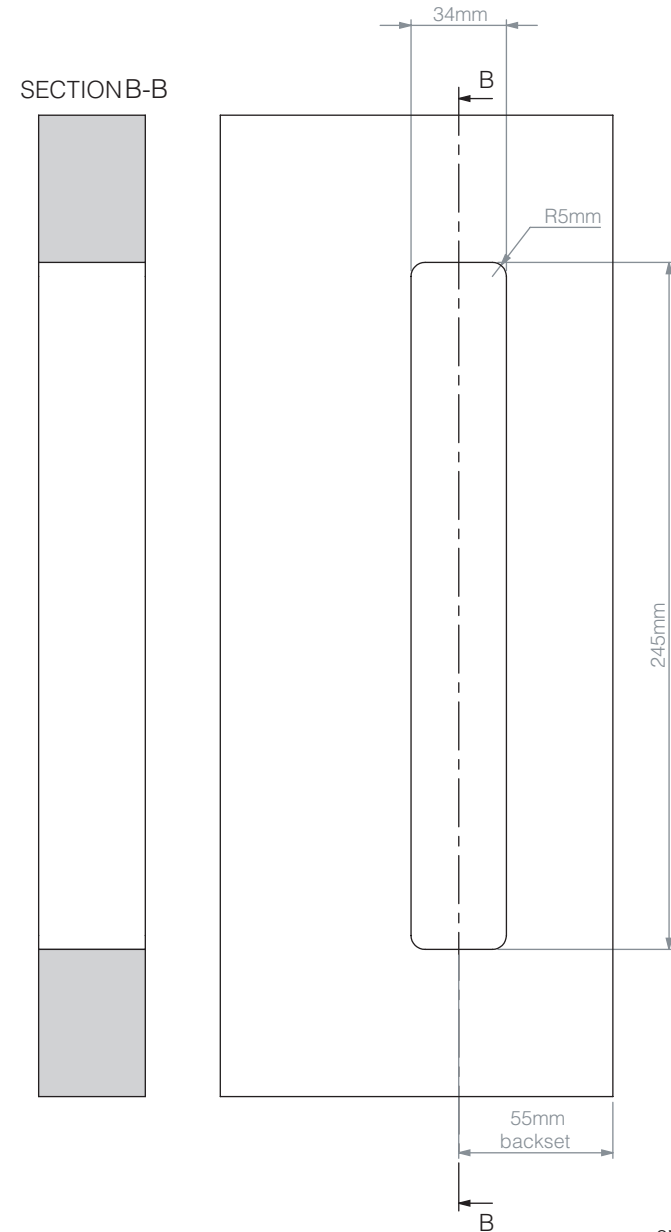



**Product Codes**  
5730, 5830, 5740, 5840

**LUME - Euro Locking - Timber Door - LOCK CASE (55mm Backset)**

- A. Cut 3mm face plate rebate.
- B. Select lock case rebate option 1 or option 2.
- C. Cut rebate option 1 – for face plate without integrated edge pull.
- D. Cut rebate option 2 – for face plate with integrated edge pull.
- E. Cut lock case rebate through to flush pull rebate.

**3MM FACE PLATE REBATE**

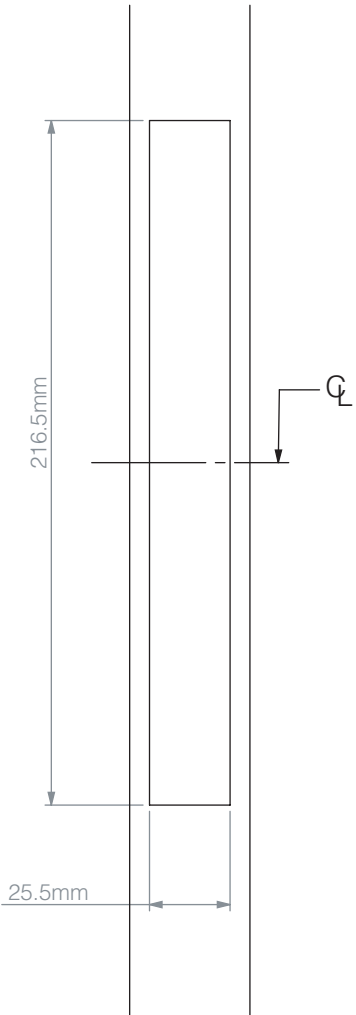

**LOCK CASE REBATE OPTION 1  
(Face plate without integrated edge pull)**

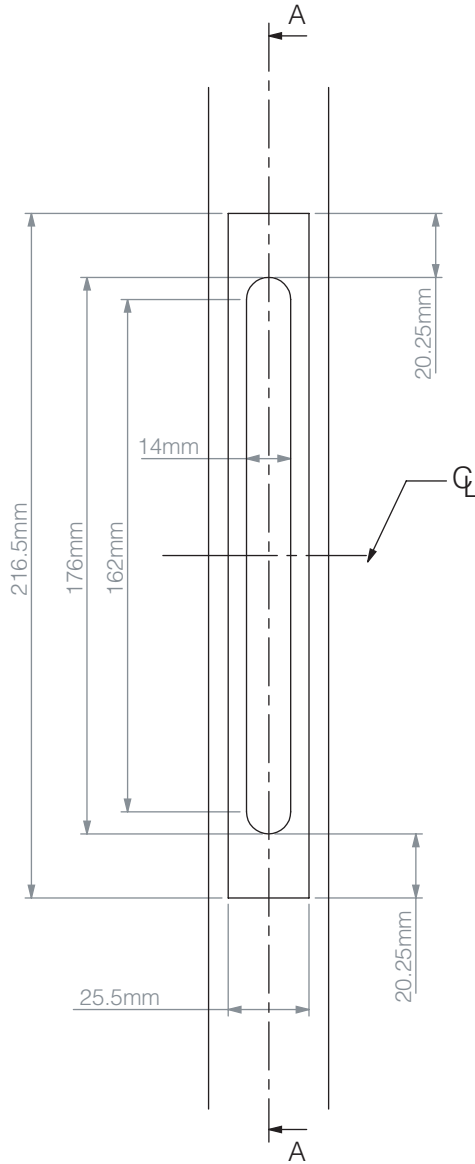

**LOCK CASE REBATE OPTION 2  
(Face plate with integrated edge pull)**

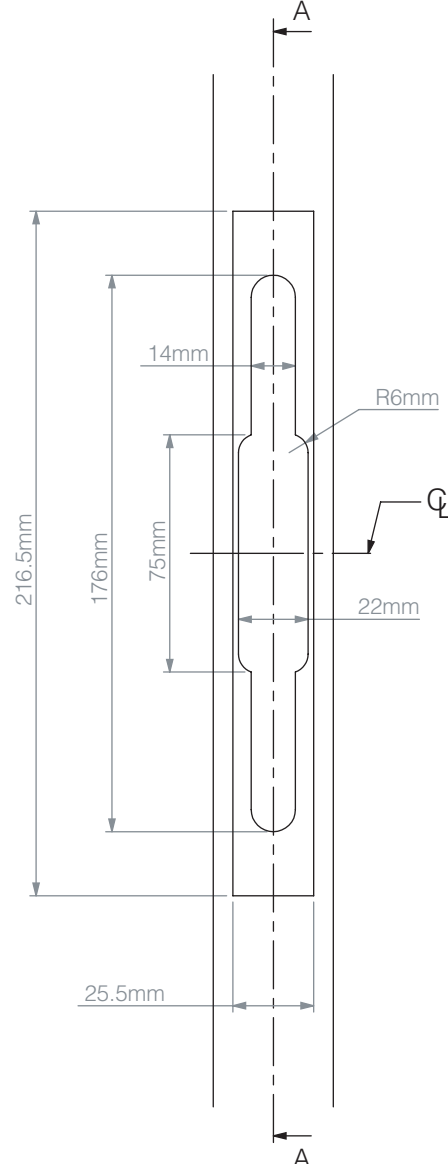

**LOCK CASE REBATE DETAILED**

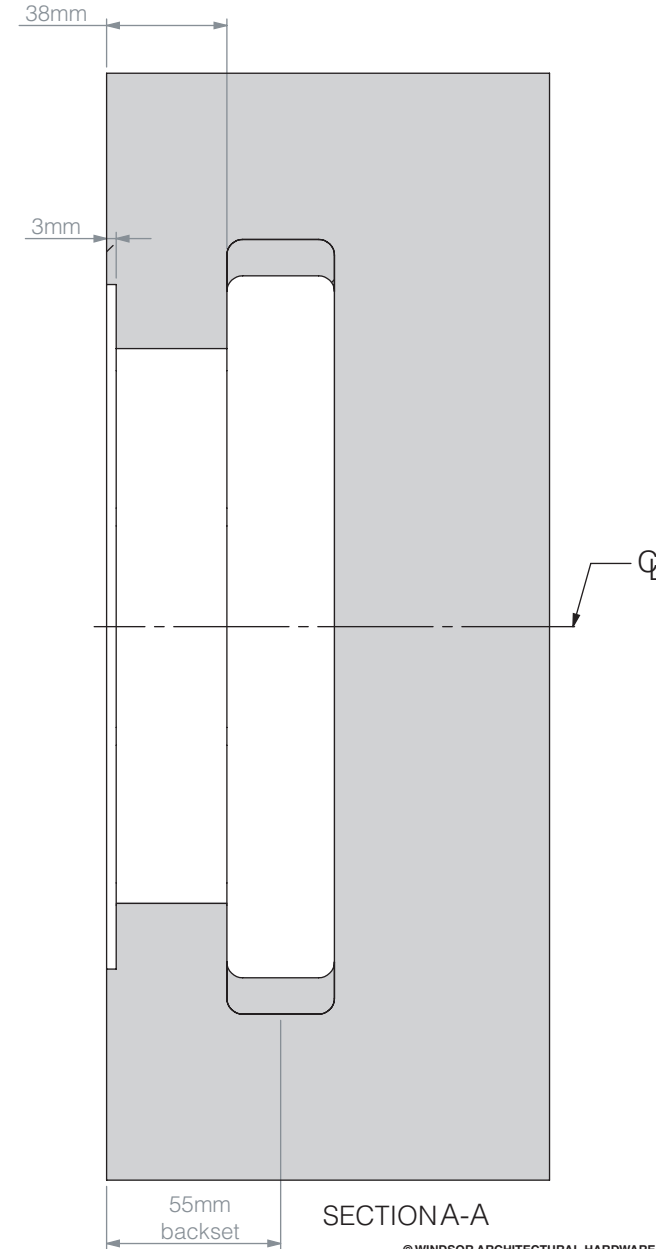

SECTION A-A



**Product Codes**  
5730, 5830, 5740, 5840

### LUME - Euro Locking - Aluminium Door

#### Step 1 - Flush Pull Crop Out\*

- A. Ensure the critical 55mm backset measurement is correct before cutting.
- B. Measured from the lockcase faceplate to the middle of the flush pull.
- C. Cut the flush pull crop out-both sides.
- D. Refer to detailed crop out template provided

**\*REFER TO DETAILED CROP OUT TEMPLATE PROVIDED.**

#### Step 2 - Lock Case Crop Out\*

- A. Select lock case crop out option 1 or option 2.
- B. Ensure the correct offset from the flush pull cropout.
- C. Cut rebate option 1 – for face plate without integrated edge pull.
- D. Cut rebate option 2 – for face plate with integrated edge pull.

**\*REFER TO DETAILED CROP OUT TEMPLATE PROVIDED.**

Installation Diagram

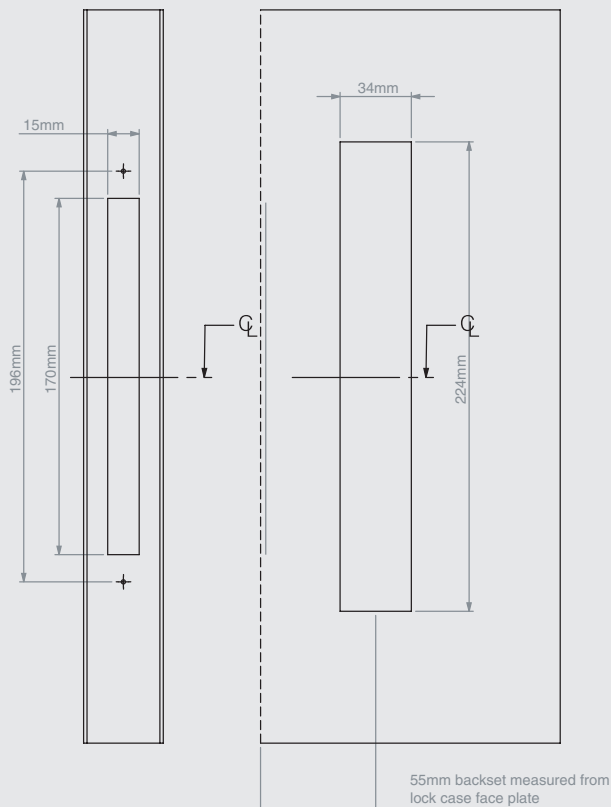

#### Step 3 - Lock Case Install

- A. Install the lock case.
- B. Use the two supplied screws to fix the lock case in place.
- C. Ensure the face plate sits up against the aluminium face.

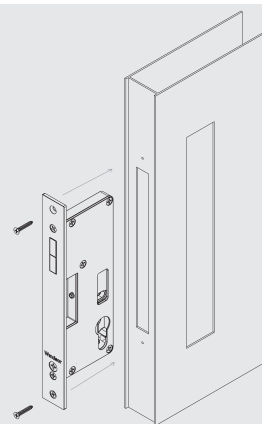

#### Step 4 - Snib Action Flush Pull Install

- A. Install flush pull with snib action.
- B. Ensure the top fixing grub screw is flush or sub flush with face A.
- C. Insert the flush pull in place ensuring that face B sits hard up against the door face.
- D. Tighten the top fixing grub screw to lock the flush pull in place.

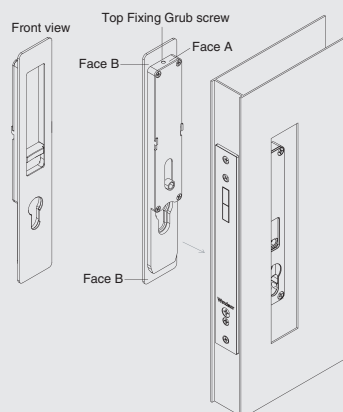



**Product Codes**  
5730, 5830, 5740, 5840

### LUME - Euro Locking - Aluminium Door

#### Step 5 - Snib to Snib Flush Pull Install

- Select the correct length snib rod for the door thickness.
- Install the snib rod - guide the snib rod through the lock case throw and into the pre-installed flush pull snib.
- With the snib rod in place. Install the flush pull repeating [Step 4](#). Ensuring the snib engages with the snib rod.
- Tighten the top fixing grub screw to lock the flush pull in place.
- Test the assembly by moving one or both flush pull snibs. Correct operation will open the lock case Mortice.

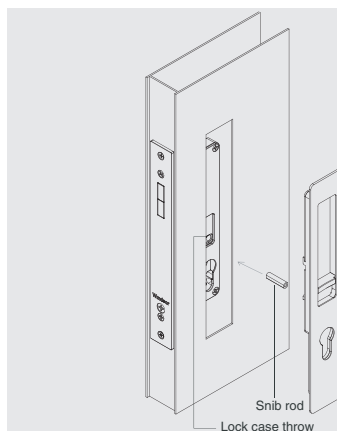

Privacy Snib to Emergency Release	
Door Thickness	Snib Rod Length
35mm	22mm
38mm	22mm
40mm	24mm
42-65mm	50-cut down to custom

#### Step 7 - Euro Cylinder Installation

- Choose the correct length Euro cylinder for the door thickness.
- Insert the Euro cylinder through flush pull and lock case to align cylinder screw.
- Use the supplied cylinder screw to lock the cylinder in place.
- Test the lock with the key to ensure a correct install.

#### Tips

- If alignment issues occur between flush pull and lock case, slightly loosen flush pull grub screws and all 4 face plate screws to allow adjustment.
- Once the cylinder is in the correct position. Tighten the fixings.
- Use the key to help guide the cylinder in place.

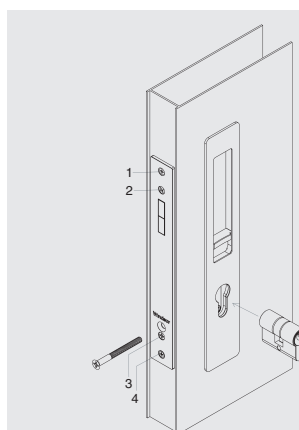

Cylinders C4 3pin - Key to Key	
Door Thickness	Cylinder Length
35-37mm	40mm
38-42mm	44mm
43-50mm	52mm
51-58mm	60mm

Cylinders C4 3pin - Single Key	
Door Thickness	Cylinder Length
35-37mm	20mm
38-42mm	22mm
43-50mm	26mm

#### Step 7 - Aluminium Door Strike Installation

- Ensure strike centre point aligns with lock case mortice centre point.
- Mark hole centres and predrill holes.
- Use the self-tapping screws to fix strike in place. For correct mortice alignment.
- Adjust vertical alignment on slotted holes before tightening.
- Adjust strike position using two adjustment screws.
- Test the strike with the mortise to ensure correct installation.

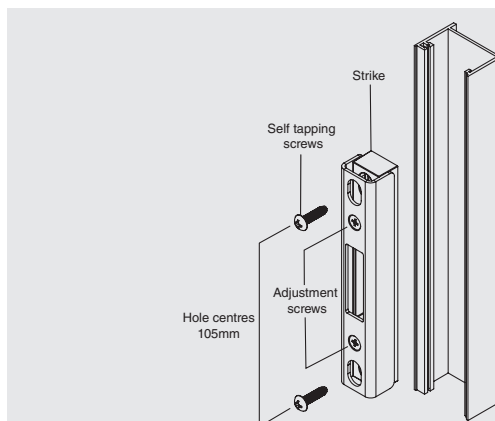



**Product Codes**  
 5730, 5830, 5740, 5840

**LUME - Euro Locking - Aluminium Door - FLUSH PULL (250mm)**

- A. Ensure the critical 55mm backset measurement is correct before cutting.
- B. Measured from the lockcase faceplate to the middle of the flush pull.
- C. Cut the flush pull crop out-both sides.
- D. Refer to detailed crop out template provided

- A. Select lock case crop out option 1 or option 2.
- B. Ensure the correct offset from the flush pull cropout.
- C. Cut rebate option 1 – for face plate without integrated edge pull.
- D. Cut rebate option 2 – for face plate with integrated edge pull.

### LOCK CASE CROP OUT OPTION 1 (Face plate without integrated edge pull)

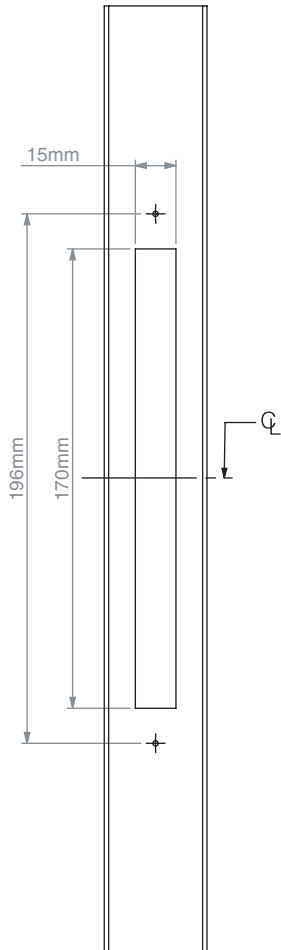

### FLUSH PULL CROP OUT (common)

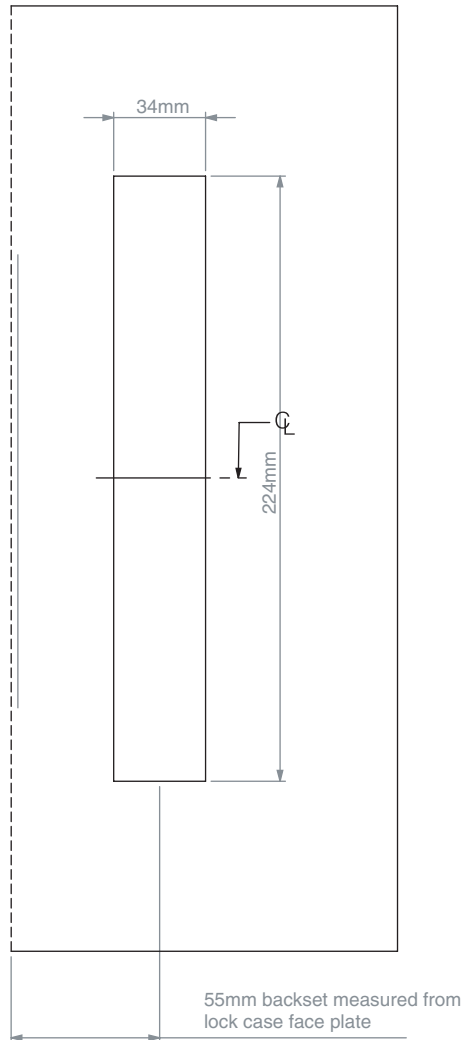

### LOCK CASE CROP OUT OPTION 2 (Face plate with integrated edge pull)

