

### DOUBLE TURN LOCK KIT | MINI LEVER LOCK KIT

**Product codes:**  
**1183 | 1184 | 1364 | 1365**

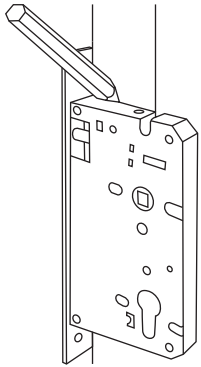

1. Position the lock body at the required height against the door edge. Using a pencil, mark the top and bottom of the lock on the door edge.

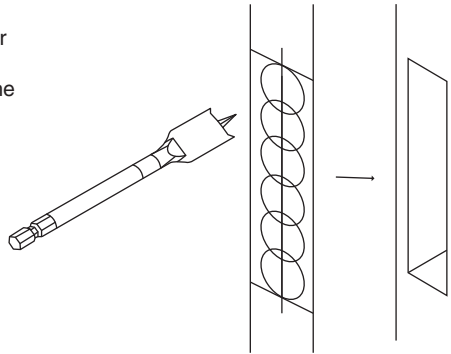

2. Between the lines of the top and bottom of the lock, mark a vertical line central to the door edge. Use this line as a guide for a series of holes to be drilled to the required depth. The hole centres should be slightly less than the drill diameter so that the drill holes overlap.

The required depth is the depth of the lock body and the fixed faceplate combined.

3. Chisel out the remaining wood to provide satisfactory clearance for the lock body. The morticed hole should be smooth and any shavings or swarf must be removed.

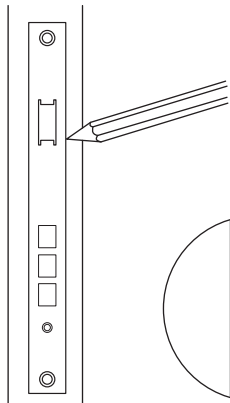

4. Insert the lock body into the morticed hole and scribe around the faceplate. Remove the lock and chisel out a recess to enable the faceplate to sit flush with the door edge.

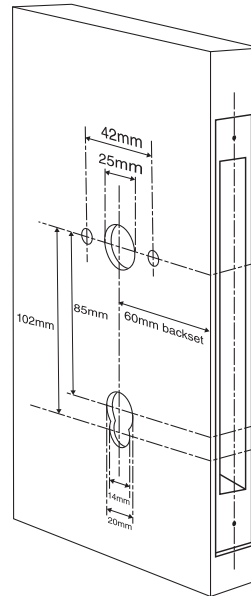
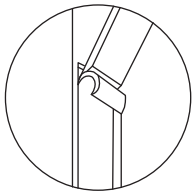

5. Mark the face of the door each side for drilling a 25mm diameter spindle hole. The centre of the spindle hole will need to be 60mm from the door edge (backset). Mark two screw holes at 21mm to the left and to the right of the centre of the spindle hole. Drill the screw holes to 6mm to accept the threaded sleeves.

6. For the cylinder hole mark a 20mm diameter hole down 85mm from the centre of the spindle hole, then mark a 14mm diameter hole down 102mm from the centre of the spindle hole on each side of the door. Ensure the centre of these holes is 60mm from the edge of the door (backset). These holes will overlap to allow for the Euro Cylinder to be inserted. For clean cut-outs, drill from both sides, meeting in the middle of the door. Ensure any loose swarf is removed from the holes.

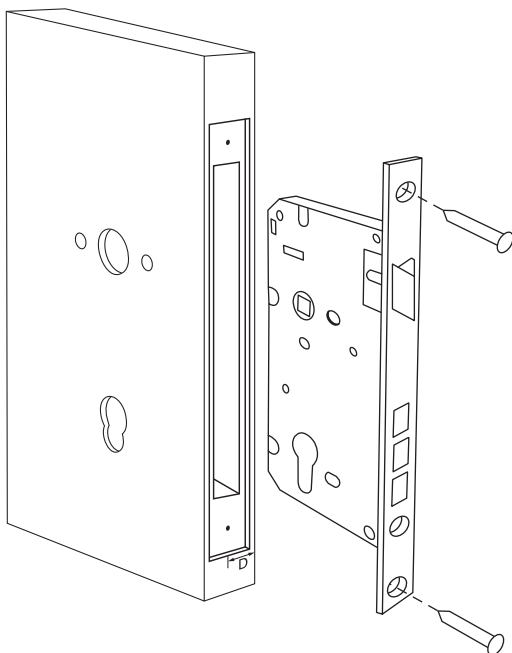

7. Check the latch tongue is facing the correct way to latch on the door frame, reverse if necessary by lifting up the tab behind the latch tongue, push the latch tongue into the lock case and rotate 180 degrees, then release the latch tongue and ensure the tab is returned to the downward position. Insert the lock into the morticed hole. Pre-drill the faceplate fixing holes for the screws and secure the lock in place. Check that the spindle and cylinder fit within the prepared holes and that they operate the lock correctly.

### DOUBLE TURN LOCK KIT | MINI LEVER LOCK KIT

**Product codes:**  
**1183 | 1184 | 1364 | 1365**

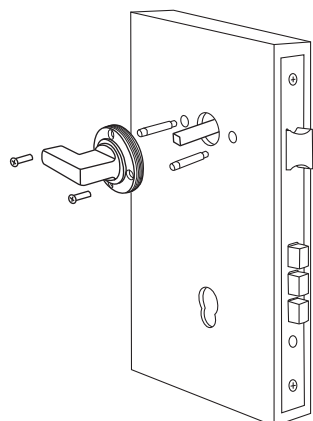

8. Unscrew the rose covers from the round roses or pull off the rose covers from the square roses.
9. Insert the spindle into the mortice lock so an even amount protrudes on each side of the door. Ensure the grooved side of the spindle will align with the grub screws on the turns.
10. Insert the threaded sleeves into the oval holes in the back of the rose of one turn at two horizontal positions. Screw the short bolts from the top of the rose through into the threaded sleeves.
11. Slide the turn over the spindle and press against the door.

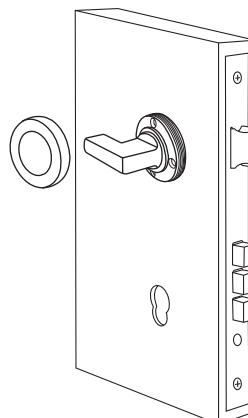
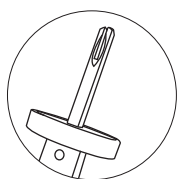

12. Insert the other turn on the opposite side of the door over the spindle and tighten the long bolts through the rose into the threaded sleeves.

13. Screw on the rose covers and tighten the grub screws onto the spindle. For the square rose press on the rose covers and tighten the grub screws on the side of the rose.

#### Notes:

If no through fixing screws are provided use the wood screws instead.  
The grub screws may need a re-tighten after a bedding-in period. We recommend medium strength thread-lock to be used, Windsor code: 1276

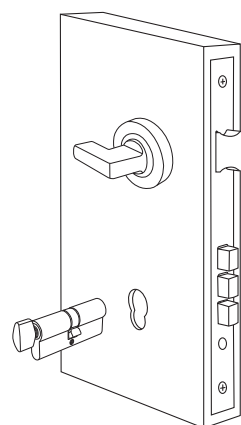

14. Insert the euro cylinder through into the lock case and fasten it with the cylinder screw provided.

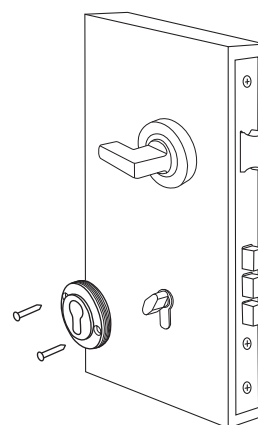
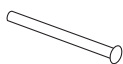

15. Fit the euro escutcheons around the cylinder on both sides of the door and fasten them with the wood screws provided.

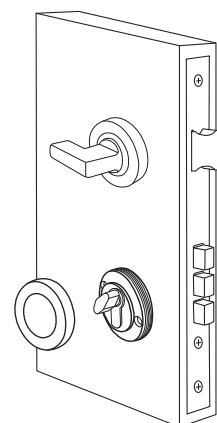

16. Screw on or push on the rose covers for the escutcheons. For the push-on covers tighten the grub screws on the side of the covers onto the roses.

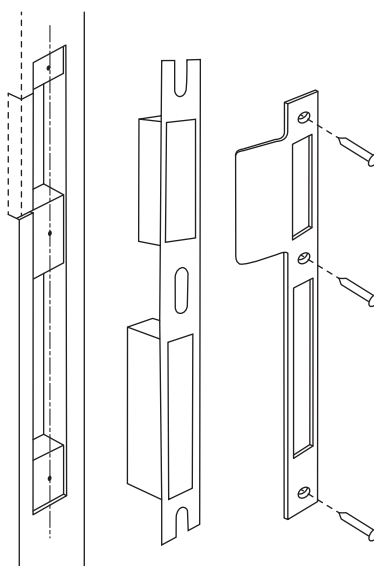

17. For fitting of the striker, close the door against the frame and mark the latch and bolts for position of the striker. Router or chisel so the striker fits flush, allowing for the plastic dustbox behind the striker, using the dustbox as a guide for depth. Insert the dustbox behind the striker and fix the striker to the door frame with the wood screws provided.